



Flat 123 Mariner Point Brighton Road | | Shoreham-By-Sea

BN14 2DU

WB
WARWICK BAKER
ESTATE AGENT

ESTATE AGENT



Flat 123 Mariner Point Brighton Road | | Shoreham-By-Sea | BN43 6DH

£500,000

*** £500,000 ***

WARWICK BAKER ESTATE AGENTS ARE DELIGHTED TO OFFER TO THE MARKET THIS TRULY UNIQUE PENTHOUSE APARTMENT NESTLED ON THE TRANQUIL RIVER ADUR IN THE CHARMING SHOREHAM BY SEA.

MARINER POINT IS A SPECTACULAR MODERN DEVELOPMENT COMPLETED IN 2019, JUST A MINUTE'S STROLL FROM THE VIBRANT SHOREHAM TOWN CENTRE. ENJOY AN IDEAL LOCATION NEXT TO THE SUSSEX YACHT CLUB AND THE CONVENIENT FOOTBRIDGE LEADING YOU STRAIGHT TO THE STUNNING BEACH.

- UNIQUE PENTHOUSE APARTMENT
- MARINER POINT DEVELOPEMNT
- ON THE RIVER NEXT TO THE FOOTBRIDGE
- DUAL-ASPECT 20' X 15'3" OPEN PLAN LIVING ROOM / KITCHEN
- TWO DOUBLE BEDROOMS, MASTER WITH ENSUITE
- MODERN KITCHEN WITH ISLAND
- SOUTHERLY ASPECT TERRACE WITH RIVER VIEWS
- 24'7" X 19'8" TERRACE WITH COUNTRYSIDE VIEWS
- BASEMENT CARPARKING
- OWNER SUITED - PLEASE CALL TO VIEW - 01273 461144

LEASEHOLD - OUTGOINGS

LEASE REMAINING – 125 years
from and including 1 January 2018 –
117 YEARS

GROUND RENT – £300 PER
ANNUM

MAINTENANCE – £3,000 PER
ANNUM APPROX.

PARKING SPACE

No: 54



Brighton Road, Shoreham-by-Sea, BN43

Approximate Area = 851 sq ft / 79 sq m
For identification only - Not to scale

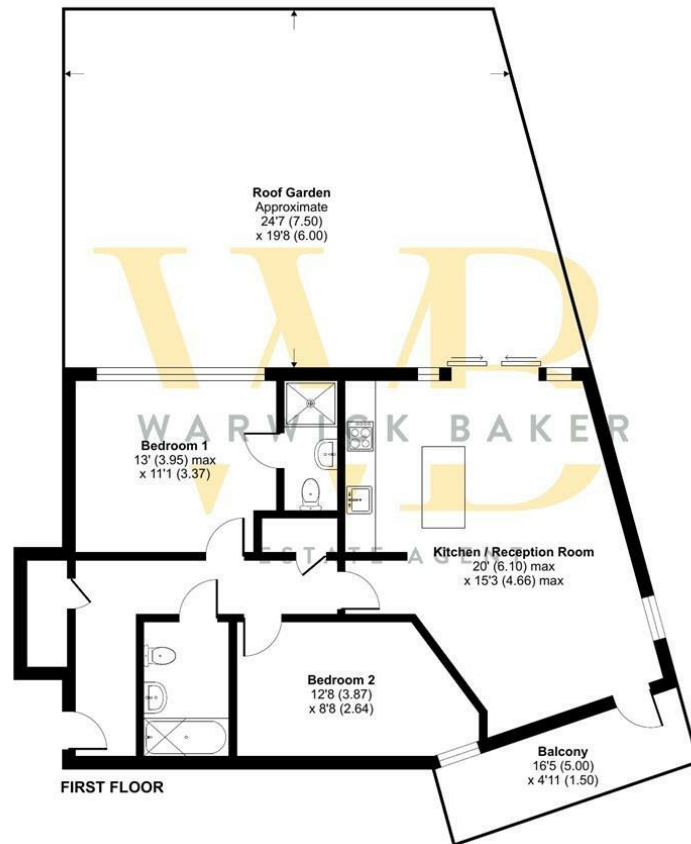

Floor plan produced in accordance with RICS Property Measurement 2nd Edition, incorporating International Property Measurement Standards (IPMS2 Residential). Produced for Warwick Baker Estate Agent Ltd. REF: 1329440. ©richcom 2025.

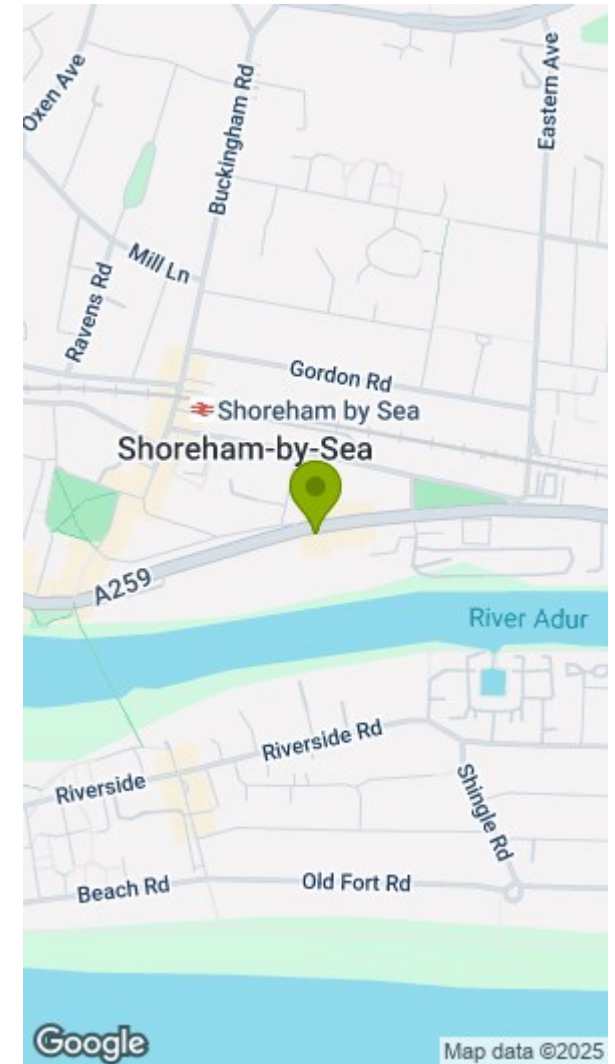

Disclaimer

- * These particulars are intended to give a fair and substantially correct overall description for the guidance of intending purchasers and do not constitute an offer or part of a contract. Prospective purchasers and/or lessees ought to seek their own independent professional advice.
- * All descriptions, dimensions, areas, references to condition and necessary permissions for use and occupation and other details are given in good faith and are believed to be correct, but any intending purchasers should not rely on them as statements or representations of fact, but must satisfy themselves by inspection or otherwise as to the correctness of each of them.
- * All measurements are approximate

Energy Efficiency Rating		Environmental Impact (CO ₂) Rating			
	Current	Potential		Current	Potential
Very energy efficient - lower running costs			Very environmentally friendly - lower CO ₂ emissions		
(92 plus) A			(92 plus) A		
(81-91) B			(81-91) B		
(69-80) C			(69-80) C		
(55-68) D			(55-68) D		
(39-54) E			(39-54) E		
(21-38) F			(21-38) F		
(1-20) G			(1-20) G		
Not energy efficient - higher running costs			Not environmentally friendly - higher CO ₂ emissions		
England & Wales	EU Directive 2002/91/EC		England & Wales	EU Directive 2002/91/EC	